

SZ and SZA tanks

Receivers SZ Jacketed receivers SZA From 63 L to 630 L

- Glass lined vertical receivers.
- Dimensions to DIN 28018.
- Design: pressure: - 1 bar to + 6 bar for vessel and jacket.
- Design temperature: - 25°C to + 200°C.
- Two pieces execution with clamped top cover, without or with heating jacket.
- Support by legs, lugs or ring.

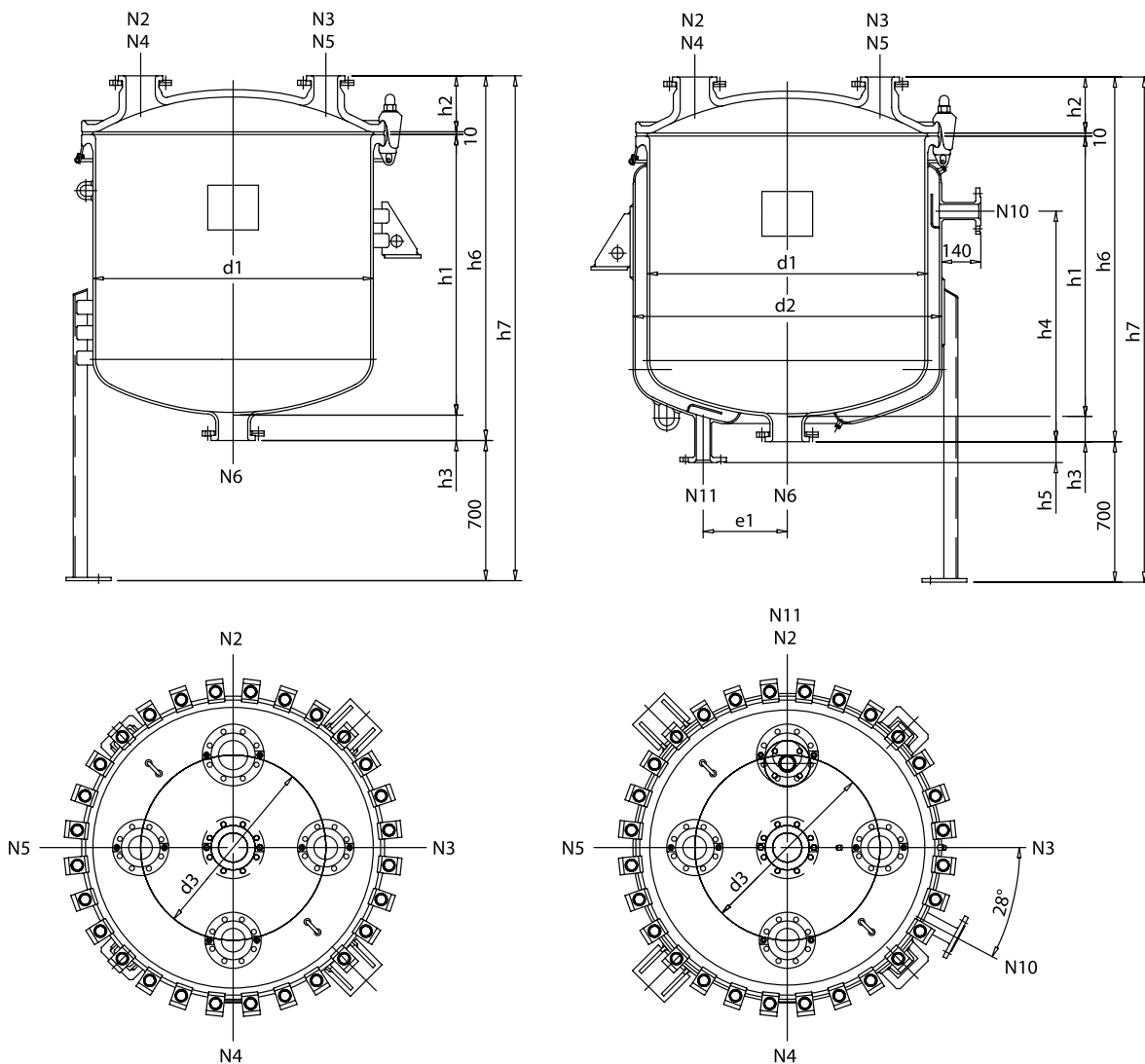

SZ and SZA tanks

		Tank						
Dimensions	Type	SZ	63	100	160	250	400	630
	Total capacity	L	80	120	190	295	485	790
	d1	mm	508	508	600	700	800	1.000
	h1	mm	400	600	700	800	1.000	1.000
	h2	mm	150	150	160	170	170	200
	h3	mm	80	80	80	80	90	90
	h6	mm	640	840	950	1.060	1.270	1.300
	h7	mm	1.340	1.540	1.650	1.760	1.970	2.000
Nozzles	d3	mm	320	320	360	440	540	660
	N2	DN	100	100	100	100	100	100
	N3 - N5	DN	50	50	50	50	80	80
	N4	DN	80	80	80	80	80	80
	N6	DN	80	80	80	80	100	100
Weight	kg	200	250	350	440	500	700	

		Jacketed tank						
Dimensions	Type	SZ	63	100	160	250	400	630
	d2	mm	600	600	700	800	900	1.100
	e1	mm	225	225	225	225	300	300
	h4	mm	245	445	545	630	830	810
	h5	mm	94	94	99	102	76	86
Nozzles	N10 - N11	DN	40	40	40	40	40	50
	N12	DN	G 1/4	G 1/4	G 1/4	G 1/4	G 1/4	G 1/4
	Jacket capacity	L	22	36	54	88	110	140
	Jacketed area	m ²	0,58	0,88	1,25	1,7	2,5	3,1
	Weight	kg	250	320	450	550	640	920

